

LX330C

Direct LED Commercial Lite Integrated HDTV

- ▶ **42LX330C**
42" class (42.16" diagonal)
- ▶ **32LX330C**
32" class (31.65" diagonal)



LG provides the ability to facilitate communications between businesses and their target audience. With our expanded line of affordable commercial display solutions, LG is aggressively meeting clients' demands for digital out-of-home technologies.

The LX330C is a great solution for many different application settings ranging from hospitality, restaurants, education, and beyond...You will discover new features and benefits that includes new welcome screen and welcome video options, self diagnostics via USB device, enhanced low power management and more!

FOR EFFICIENT MANAGEMENT

PUBLIC DISPLAY MODE
From channel selection to energy-saving features, Public Display Mode allows you to control the TV settings in your business area, prevent misuse by customers, set volume limits, or restore factory defaults on any TV. You are in control of it all.



USB CLONING
The USB Cloning feature allows you to simply copy the TV settings onto all TVs using a USB stick, a process that is fully automated to save time without having to set each TV one by one.



WELCOME SCREEN
Welcome visitors with a warm greeting message that includes your business name/logo and now with a video or both.



MULTI IR
Multi IR function eliminates the remote control signal interference between TVs in multiple dwelling rooms. This system will work using the same LG TV model. (Optional 124-213-10 required)



RS232C CONTROL
Via the TV's RS-232C port, you can remotely control multiple TVs' power and volume settings simultaneously.



FOR CONVENIENCE & ENTERTAINMENT

EXTERNAL SPEAKER OUT
Enhance the entertainment experience by adding an additional speaker, visitors to listen to and control the TV audio from anywhere in your business area, including restrooms.



IR OUT
IR Out enables customized set top boxes to receive IR signals via LG TV Signage. This added convenience requires only simple connections and allows easy management using a single remote control.

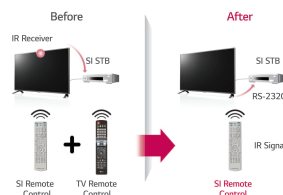

USB 2.0
You can play images and videos from and record TV programs to external storage devices. Immediate recording & reserved recording options are available.



LX330C

Direct LED Commercial Lite

Integrated HDTV

- ▶ **42LX330C**
42" class (42.16" diagonal)
- ▶ **32LX330C**
32" class (31.65" diagonal)

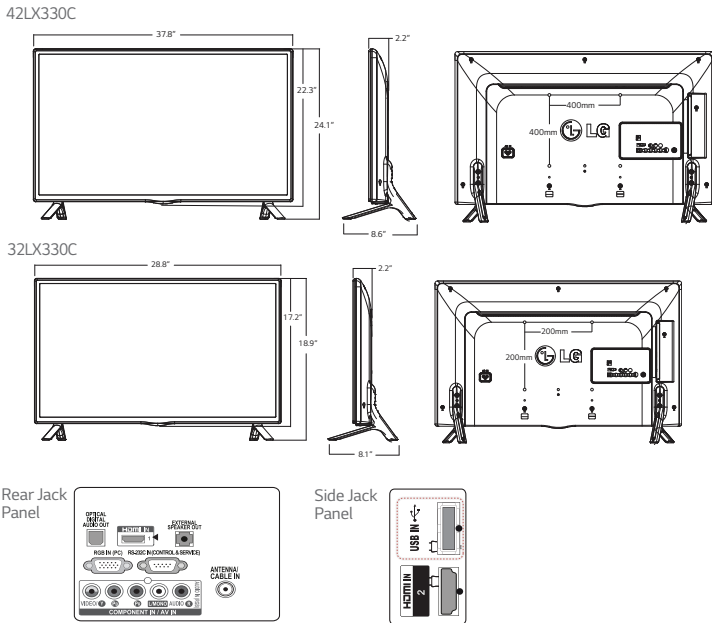

PANEL	MODEL	42LX330C	32LX330C
	Panel Size	42" class (42.16" diagonal)	32" class (31.65" diagonal)
	Backlight Type	Direct LED	
	Resolution	1920 x 1080 (FHD)	1366 x 768 (HD)
	Brightness (Average)	240cd/m ²	
	Dynamic Contrast Ratio	1,000,000:1	
	Contrast Ratio	1200 :1	
	Viewing Angle	178°x178°	
	Response Time(G to G)	8ms	9ms
	Frame Rate	60Hz	
BROADCAST SYSTEM	Analog	Yes (NTSC)	
	Digital	ATSC/QAM/VSB	
VIDEO	Triple XD Engine	Yes	
	Dynamic Color Enhancer	Yes	
	Real Cinema 24p (3:3 pull down)	Yes	
	Aspect Ratio	6 modes (16:9, Just scan, Set by program, 4:3, Zoom, Cinema zoom 1)	
AUDIO	Audio Output	10W + 10W	
	Speaker System	2.0 ch	
	Sound Mode	6 modes (Standard, News, Music, Cinema, Sport, Game)	
	Optical Sound Sync	Yes	
	Sound Optimizer	3 modes (Normal, Wall-Mount Type, Stand Type)	
	Clear Voice	Yes	

ENERGY GUIDE

The estimated annual energy cost determined in accordance with 16 CFR Part 305.5 for models 42LX330C and 32LX330C are \$9 and \$6 respectively.

*Your energy cost depends on your utility rates and use. The estimated cost is based on 11 cents per kWh and 5 hours of use per day. For more information, visit www.ftc.gov/energy/

†FTC Television labeling rule (18 CFR Part 305, as added by 76 Fed. Reg. 1038 (Jan 6, 2011)).

FEATURES	MODEL	42LX330C	32LX330C	
	Remote Diagnosis	Yes (Self Diagnosis (USB))		
	HDMI-CEC	Yes (ARC Not Supported)		
	HTNG-CEC	Yes		
	Menu	PDM only		
	Lock Mode	Yes		
	External Speaker Out	1 (Variable/Fixed/Line Out, 3.5mm, Stereo, Single Ended Type (GND,L+,R+), 1W with 8Ω)		
	RJP Interface	Yes (RS232C,HDMI)		
	RJP Compatibility	Teleadapt (RS232C), Teleadapt/Guestlink (HDMI CEC)		
	USB	Yes (USB 2.0)		
	USB Auto Play back	Yes		
	Moving Picture Playback (SD/HD/Plus HD)	Divx HD		
	Picture	JPEG		
	Audio Codec	MP3, AC3, MPEG, AAC,HEAAC, CDDA, LPCM		
	USB Cloning	Yes		
	Multi IR Code	Yes		
	Welcome Screen (Splash Image)	Yes		
	Auto Off / Auto Sleep	Yes		
	Motion Eye Eare	Yes		
	Kensington Lock	Yes (back cover)		
INTERFACE	HDMI In	2 (1 Rear, 1 Side)		
	USB (2.0)	1		
	RF In	1		
	AV In	1 (Sharing w/Component in)		
	Component in (Y,Pb,Pr) + Audio	1		
	Digital Audio Out (Coaxial / Optical)	1 (Optical)		
	HDMI/HDCP Input	1		
	RGB In (D-sub 15pin) - PC	1		
	PC Audio Input	1 (Sharing with Component Audio)		
	RS-232C (D-Sub 9pin)	1		
	External Speaker Out (3.5mm phone jack)	1 Variable/Fixed/Line Out, 3.5mm, Stereo, Single ended Type (GRD,L+,R+), 1W with 8Ω		
	ACCESSORIES	Cable	Power cord (1.55m, Angle Type)	
		Manual / ESG	Simple Manual	
	POWER	Voltage	100 - 240V, 50/60Hz	
		Typical (Based on Energy Star 7.0)	39W	28W
	Stand-by	0.5W ↓		
CABINET	Bezel Color	Lucido Titan		
	Stand Color	Black		
	Bezel Width - ON (Left/Right, Upper, Bottom)	11.0mm, 11.0mm, 16.5mm	11.6mm, 11.3mm, 16.3mm	
	Bezel Width - OFF (Left/Right, Upper, Bottom)	8.5mm, 8.5mm, 14.0mm	10.5mm, 10.0mm, 14.0mm	
	Flame Retardant	Yes		
	VESA Compatible	400mm x 400mm	200mm x 200mm	
	WxHxD (with stand)	37.8" x 24.1" x 8.6"	28.8" x 18.9" x 8.1"	
	Weight	20.9lbs	13.7 lbs	
	WxHxD (w/o stand)	37.8" x 22.3" x 2.2"	28.8" x 17.2" x 2.2"	
	Weight	20.3 lbs	13.2 lbs	
WxHxD (carton)	41.7" x 26.0" x 6.0"	32.1" x 20.1" x 6.0"		
Weight	25.6 lbs	16.3 lbs		
REQUIRED LISTING (CERTIFICATION)	Safety	UL		
	EMC	FCC		
	ETC	RoHS, cJL, NOM, Energy Star 7.0		
WARRANTY	2-Year Limited Warranty Parts/Labor/Backlight Extended warranty options are also available			
OTHER	UPC	7 19192 19694 0	7 19192 19695 7	



LG Electronics U.S.A., Inc.
HE B2B Division
2000 Millbrook Drive
Lincolnshire, IL 60069

Customer Service: 888.865.3026
Channel: 800.997.8871
www.LGSolutions.com/support

Contact your LG Regional Sales Representative:
Hospitality: 800.228.1236
E-mail: info@LGSolutions.com

SPEC_LX330C Series_051501_PR

All screen images are simulated. Dimensions and weights are approximate. Design, features and specifications subject to change without notice.

© Copyright 2015 LG Electronics USA, Inc. All Rights Reserved. "LG Life's Good" is a registered trademark of LG Corp. XD Engine is a registered trademark of LG Electronics, Inc. HealthView and EcoSmart are trademarks of LG Corp. ENERGY STAR is a registered trademark of the U.S. Environmental Protection Agency. Dolby and the double-D symbol are registered trademarks of Dolby Laboratories. SRS and the SRS symbol, TruSurround XT and WOW are trademarks or registered trademarks of SRS Labs, Inc. VESA is a trademark of Video Electronics Standards Association. All other product and brand names are trademarks or registered trademarks of their respective companies.

Printed in the USA. May 2015